

RESIDENTIAL DECK CONSTRUCTION

TOWN OF PARADISE BUILDING DIVISION

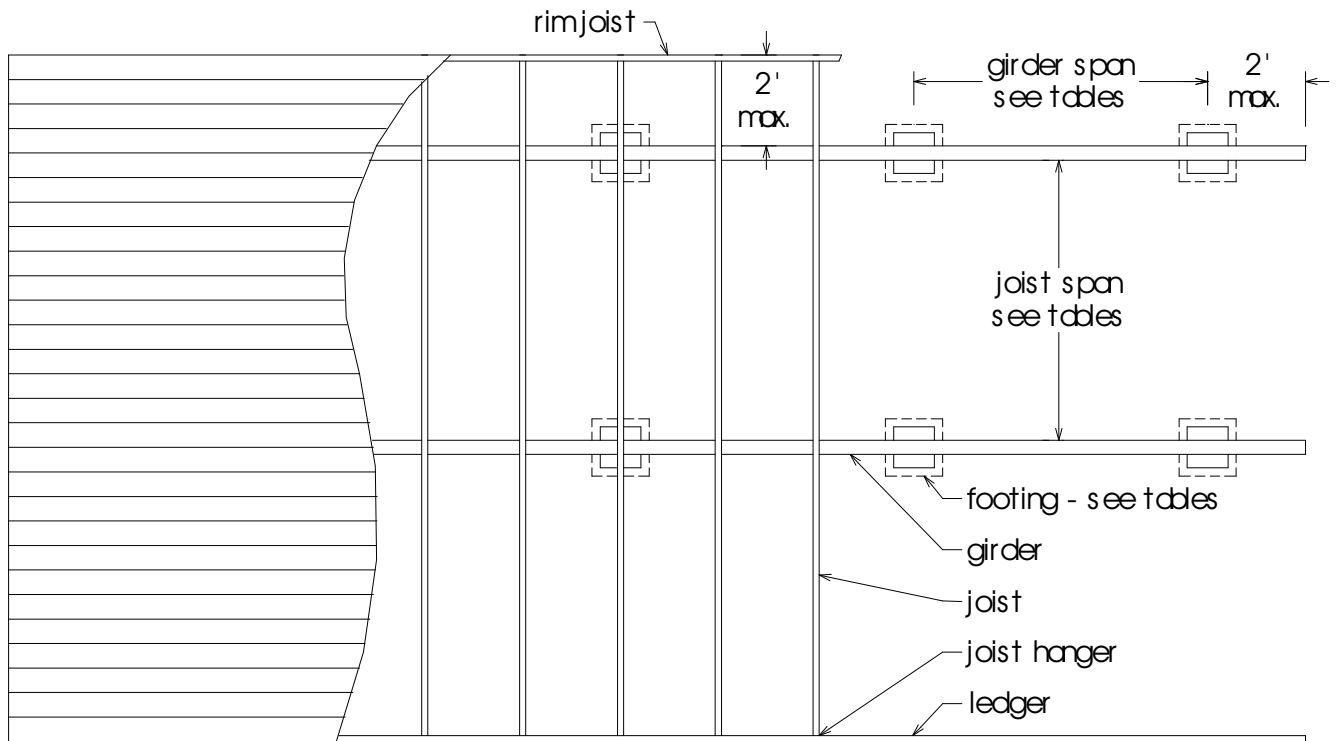

PLAN VIEW

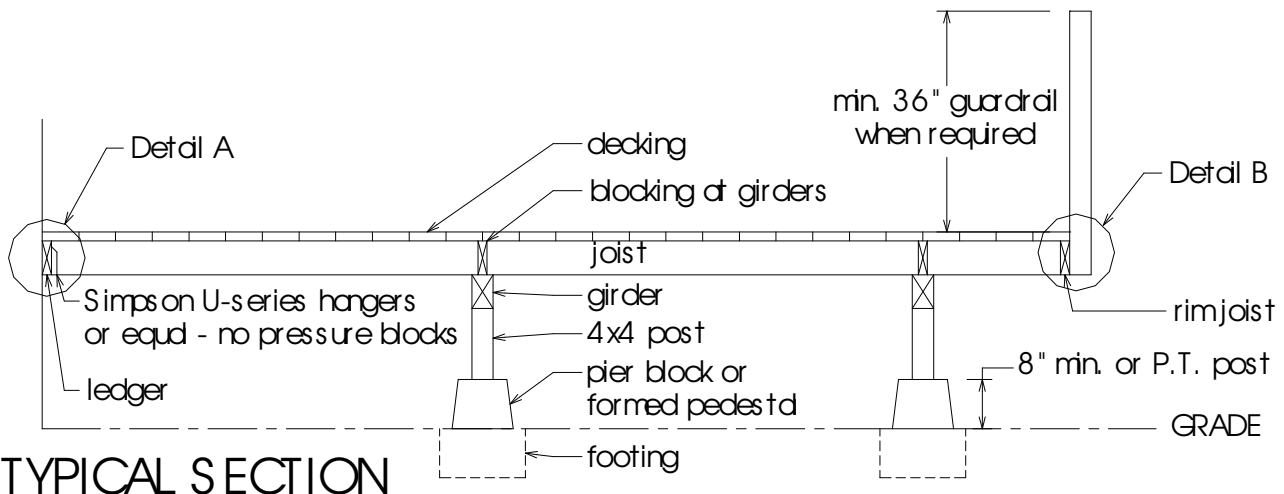

TYPICAL SECTION

NOTES:

- Nail joist to girder with 3 - 8d or 2 - 16d toenails
- Posts longer than 4' require diagonal bracing and positive tie to girder such as Simpson BC4
- Posts longer than 8' also require a wet anchor with listed concrete side cover

Options for Detail A

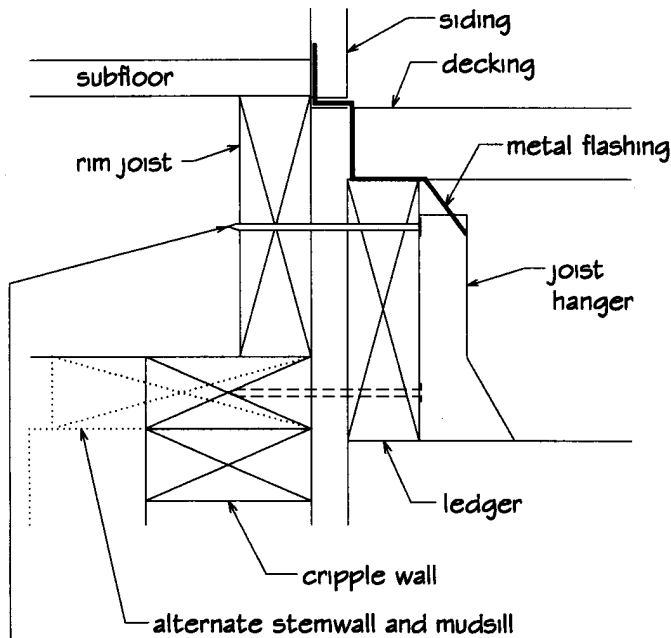

Nails long enough to penetrate through rim joist @ 6" o.φ. staggered or 3/8" lag bolts the same length @ 12" o.φ. staggered

Option 1

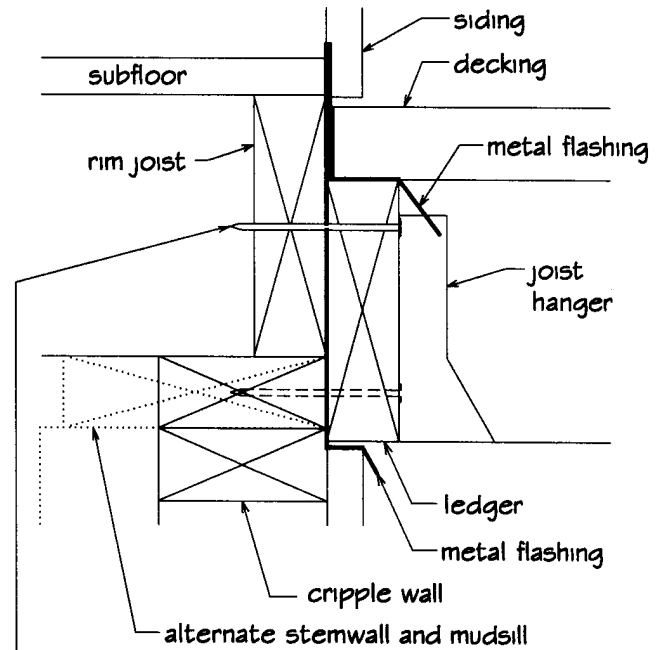

1 6d nails @ 6" o.φ. staggered or 3/8" x 3 1/2" lag bolts @ 12" o.φ. staggered

Option 2

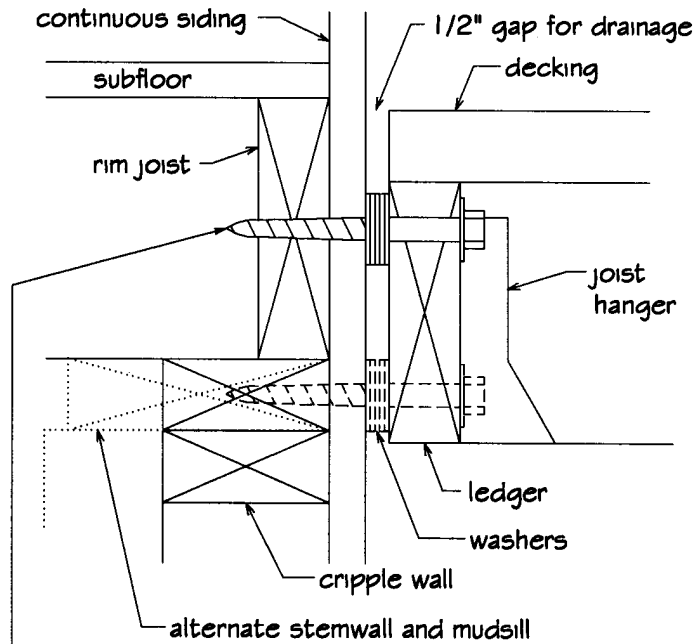

3/8 Lag bolts long enough to penetrate through rim joist @ 12" o.φ. staggered

Option 3

GUARDRAILS (CBC 509)

The intent of a guardrail is to prevent people, particularly small children, from falling off the edge of a horizontal standing surface. Open sides of floor openings, stairways, landings, ramps, balconies, or porches, which are more than 30 inches above grade or the floor below shall be protected by a guardrail.

The top of residential guardrails must be at least 36 inches above the upper standing surface. Guardrails must have intermediate rails or an ornamental pattern placed in such a manner that a sphere four inches in diameter cannot pass through. The triangular openings formed by the riser, tread and bottom element of a guardrail at the open side of a stairway may be of such size that a sphere 6 inches in diameter cannot pass through.

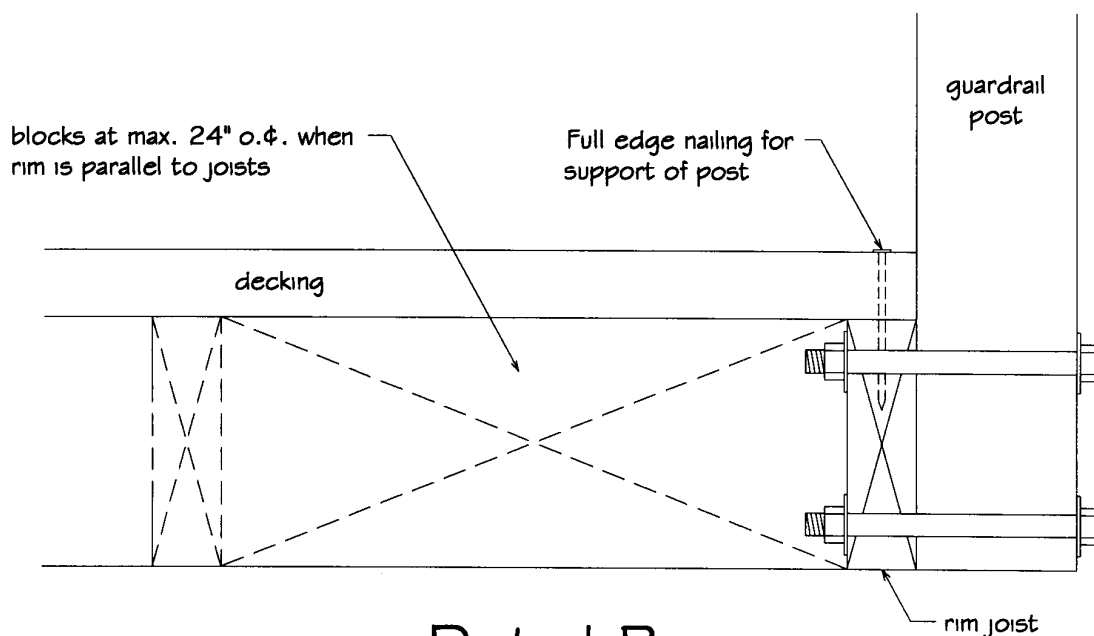
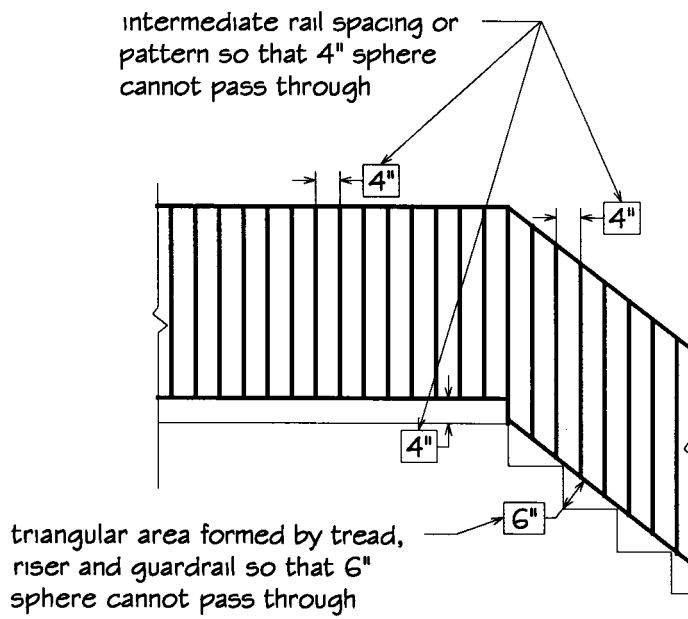

DOOR LANDINGS (CBC 1003.3.1.6-7)

All exterior doors shall have a landing immediately on the exterior side. The landing shall be as wide as the door, a minimum of 36 inches in the direction of travel, and no more than 8 inches below the interior floor level. If the door swings out over the landing this dimension is 1 inch maximum.

STAIRWAYS (CBC 1003.3.3)

Stairways shall be a minimum of thirty-six inches wide. Trim and handrails may not encroach into this minimum width by more than 3 1/2 inches on each side. The maximum rise of each step is eight inches; the minimum rise is four inches. The minimum run is nine inches. The largest tread width or riser height in any flight of stairs shall not exceed the smallest by more than 3/8 inch.

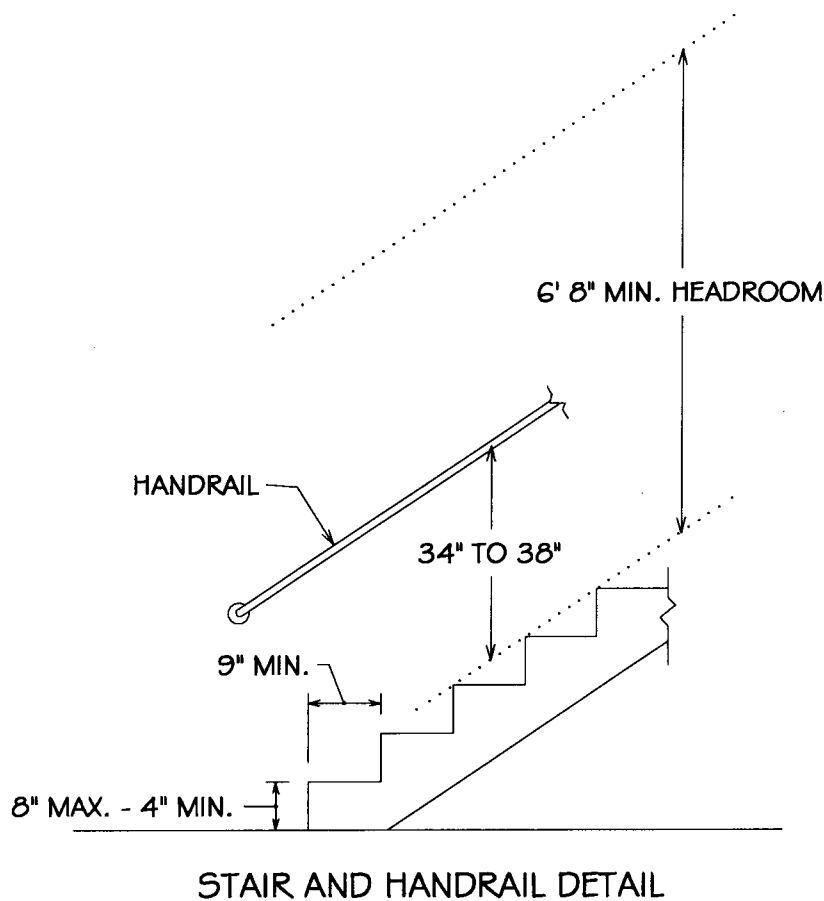

Every stairway must have a headroom clearance of not less than 6' 8" measured vertically from the plane of the tread nosing to the soffit above at all points.

Stairway landings must have a width not less than the width of the stairway and a dimension measured in the direction of travel of at least 36".

STAIRWAY HANDRAILS (CBC 1003.3.3.6)

The intent of a handrail is to provide a handgrip for people using a stairway. Stairways which serve an individual dwelling unit must have a handrail on one side if they have four risers or more. Such stairways with fewer than four risers are not required to have handrails. Handrails projecting from a wall shall have not less than 1 1/2 inches between the wall and handrail. Handrails must be placed between thirty-four and thirty-eight inches above the nosing of the stair treads. The handgrip portion of handrails shall not be less than 1 1/4 inches nor more than 2 inches in cross-sectional dimension or the shape shall provide an equivalent gripping surface. The handgrip portion of handrails shall have a smooth surface with no sharp corners.

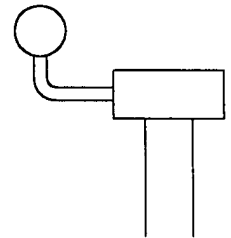
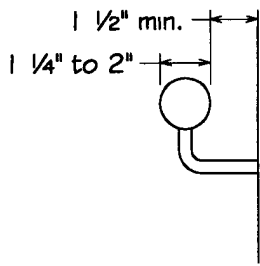

ACCEPTABLE SHAPES

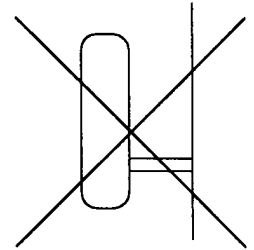
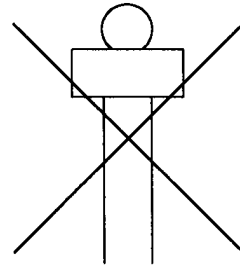
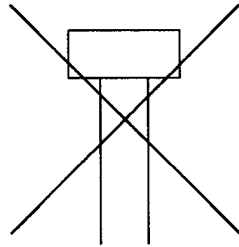
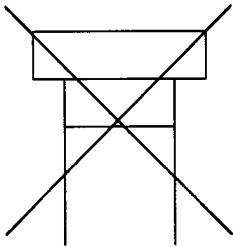

UNACCEPTABLE SHAPES