

PARKWAYS

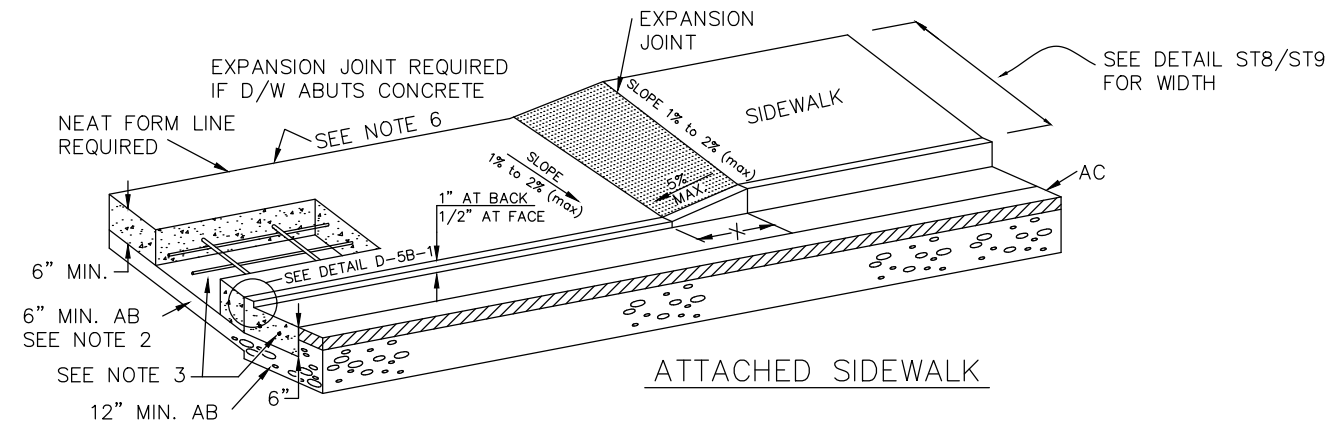

ATTACHED SIDEWALK

NOTES:

1. ALL CONCRETE REMOVALS SHALL BE TO NEAT SAW CUTLINES.
2. 95% RELATIVE COMPACTION REQUIRED ON SUBGRADE.
3. ALL DRIVEWAYS SHALL HAVE (2) NO. 4 REBARS 12" O.C. LENGTHWISE IN THE GUTTER DOWELED AND EPOXIED 6" INTO THE EXISTING CURB BOTH SIDES AND NO. 4 REBARS 18" O.C. EACH WAY THROUGHOUT THE APPROACH.
4. DRIVEWAY APPROACH SHALL BE POURED SEPARATELY FROM CURB UNLESS OTHERWISE APPROVED BY THE TOWN ENGINEER.
5. ON SITE GRADING MAY BE REQUIRED TO ELIMINATE EXCESSIVE GRADE CHANGE AND TO MAINTAIN SUITABLE DRAINAGE.
6. MAXIMUM CURB OPENING MAY BE INCREASED DUE TO SPECIAL CONDITIONS ON APPROVAL OF TOWN ENGINEER.
7. CONCRETE FOR CURBS, SIDEWALKS AND THEIR APPURTENANCES MUST BE MINOR CONCRETE CONTAINING AT LEAST 463 POUNDS OF CEMENTITIOUS MATERIAL PER CUBIC YARD OR MEET CALTRANS REQUIREMENTS IN THE STANDARD SPECIFICATIONS SECTIONS 73 & 90.
8. EPOXY PER CURRENT CALTRANS STANDARD SPECIFICATIONS
9. 90% RELATIVE COMPACTION, SAND PER CURRENT CALTRANS SPECIFICATIONS

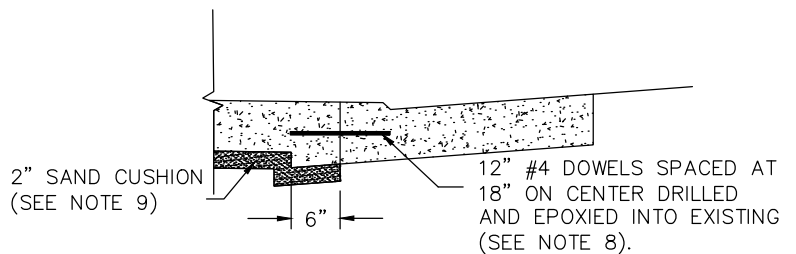

DETAIL D-5B-1

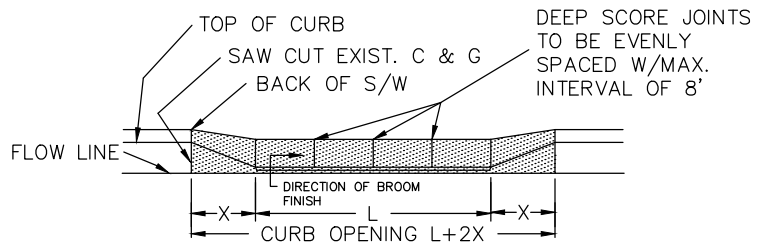

X LENGTH		MIN. L	MAX. L
PLANTER WIDTH	6" CURB		
6" AND GREATER	2'	16'	36'
LESS THAN 6"	6.7'	12'	36'
NONE	6.7'	12'	36'



**TOWN OF PARADISE
PUBLIC WORKS / ENGINEERING**

5555 Skyway
Paradise, California 95969
Phone: (530) 872-6291 Fax: (530) 877-5059

**Standard Detail D-5B
HEAVY DUTY DRIVEWAY**

[Signature]
Approved Date 3/30/2023