

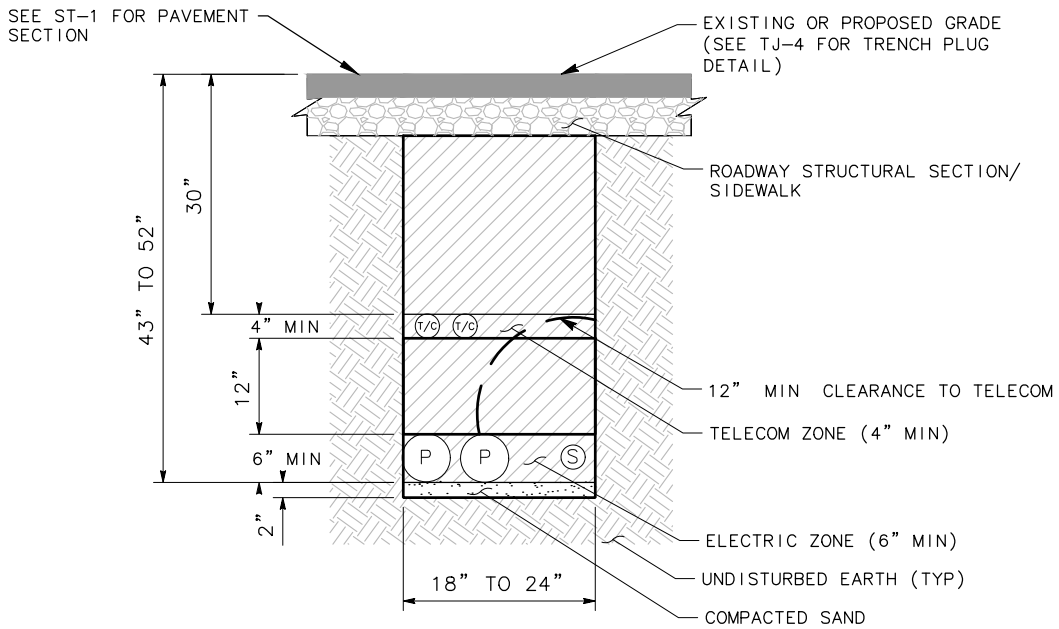



TELECOM AND GAS ONLY TRENCH

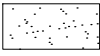

ELECTRIC & TELECOM ONLY TRENCH

LEGEND

-  NATIVE BACKFILL, 90% RELATIVE COMPACTION
-  COMPACTED SAND
-  STRUCTURAL SECTION
-  UNDISTURBED EARTH

NOTES

1. CONTRACTOR TO REPAIR ALL LANDSCAPING AND IRRIGATION REMOVED DURING CONSTRUCTION. CONTRACTOR TO STABILIZE DISTURBED AREAS.
2. DIMENSIONS OF THE PAVEMENT STRUCTURES (STRUCTURAL SECTIONS) ARE SUBJECT TO TOLERANCES SPECIFIED IN THE STANDARD SPECIFICATIONS.
3. 12" MINIMUM CLEARANCE IS REQUIRED BETWEEN PRIMARY CONDUIT & OTHER NON-SECONDARY ELECTRIC OCCUPENTS PER PG&E GREENBOOK.



TOWN OF PARADISE
PUBLIC WORKS / ENGINEERING

5555 Skyway
 Paradise, California 95969
 Phone: (530) 872-6291 Fax: (530) 877-5059

Standard Detail TJ-3
 TYPICAL JOINT TRENCH CROSS SECTIONS

[Signature]
 Approved Date 3/30/2023